

# HV V-Hooks

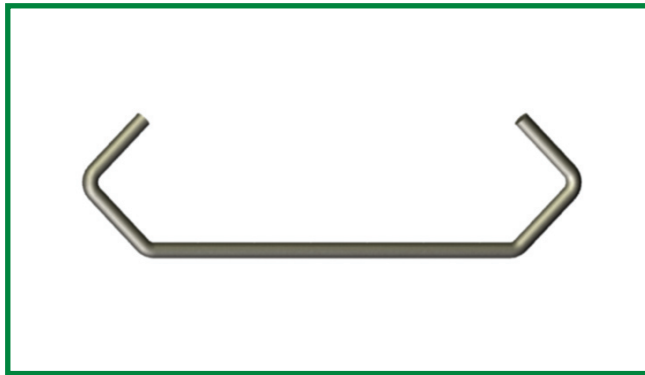

- V-Hook Geometry is Extremely Stable Under Loads (as compared to other hook geometries)
- Provides Superior Grounding (Multiple Grounding Contact Points)

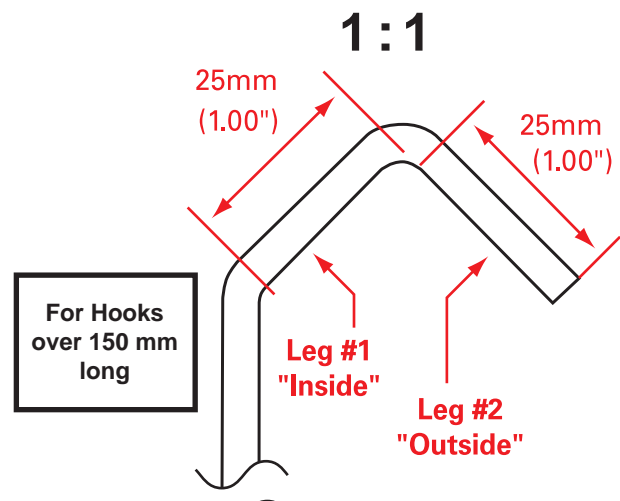
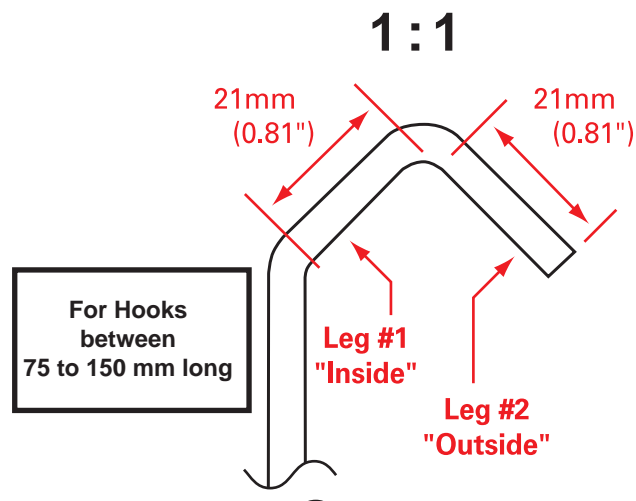

LOAD TABLE: V-Hooks			
Wire Diameter	6.0 mm	0.25"	* 80 kilos
	4.5 mm	0.18"	80 kilos
	3.0 mm	0.12"	36 kilos
	2.0 mm	0.08"	11 kilos
	1.5 mm	0.06"	5.5 kilos

Safe Load Limits

**NOTE:** The recommended safe load limits were compiled under static load conditions in a laboratory fully accredited by the American Association for Laboratory Accreditation, conforming to ISO Guide 25. Although all load limits incorporate a safety factor, many factors will affect the actual dynamic load capacity of a hook. Such factors include sudden change in line speed, vibration in the conveyor, or in the case of suspension from two hooks, a shift in the center of gravity caused by an incline or stretching along curves in the conveyor. This product should be tested to determine the suitability for its intended use.

\* Please call your EPSI representative for further details.

# HV SERIES

PART NUMBER	OVERALL LENGTH	STANDARD (IN.)			METRIC (MM)				BOX QTY
		WIRE DIA	LEG 1	LEG 2	OVERALL LENGTH	WIRE DIA	LEG 1	LEG 2	
HV 07515-2121	3	0.06	0.81	0.81	75	1.5	21	21	2500
HV 10015-2121	4	0.06	0.81	0.81	100	1.5	21	21	2500
HV 15015-2525	6	0.06	1.00	1.00	150	1.5	25	25	2500
HV 07520-2121	3	0.08	0.81	0.81	75	2.0	21	21	2500
HV 10020-2121	4	0.08	0.81	0.81	100	2.0	21	21	2500
HV 15020-2525	6	0.08	1.00	1.00	150	2.0	25	25	2500
HV 20020-2525	8	0.08	1.00	1.00	200	2.0	25	25	2500
HV 25020-2525	10	0.08	1.00	1.00	250	2.0	25	25	2500
HV 30020-2525	12	0.08	1.00	1.00	300	2.0	25	25	1000
HV 37520-2525	15	0.08	1.00	1.00	375	2.0	25	25	1000
HV 45020-2525	18	0.08	1.00	1.00	450	2.0	25	25	1000
HV 60020-2525	24	0.08	1.00	1.00	600	2.0	25	25	1000
HV 10030-2121	4	0.12	0.81	0.81	100	3.0	21	21	1000
HV 15030-2525	6	0.12	1.00	1.00	150	3.0	25	25	1000
HV 20030-2525	8	0.12	1.00	1.00	200	3.0	25	25	1000
HV 25030-2525	10	0.12	1.00	1.00	250	3.0	25	25	1000
HV 30030-2525	12	0.12	1.00	1.00	300	3.0	25	25	500
HV 45030-2525	18	0.12	1.00	1.00	450	3.0	25	25	500
HV 60030-2525	24	0.12	1.00	1.00	600	3.0	25	25	500
HV 75030-2525	30	0.12	1.00	1.00	750	3.0	25	25	250
HV 15045-2525	6	0.18	1.00	1.00	150	4.5	25	25	500
HV 20045-2525	8	0.18	1.00	1.00	200	4.5	25	25	500
HV 30045-2525	12	0.18	1.00	1.00	300	4.5	25	25	250
HV 45045-2525	18	0.18	1.00	1.00	450	4.5	25	25	250
HV 60045-2525	24	0.18	1.00	1.00	600	4.5	25	25	100
HV 15060-2525	6	0.25	1.00	1.00	150	6.0	25	25	500
HV 20060-2525	8	0.25	1.00	1.00	200	6.0	25	25	500
HV 30060-2525	12	0.25	1.00	1.00	300	6.0	25	25	250
HV 37560-2525	15	0.25	1.00	1.00	375	6.0	25	25	250
HV 45060-2525	18	0.25	1.00	1.00	450	6.0	25	25	250
HV 60060-2525	24	0.25	1.00	1.00	600	6.0	25	25	100

## Explanation of new Hook product numbers: (ie; HV 15045-2525)

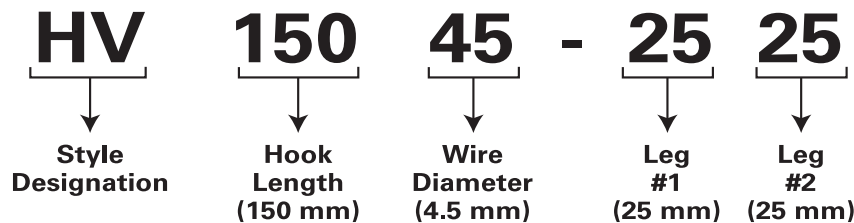

■ For current pricing and additional sizes, send your e-mail to: [ask-it@epsi-europe.com](mailto:ask-it@epsi-europe.com)



T: +31 (0)10 4150155  
F: +31 (0)10 4154099

E: [ask-it@epsi-europe.com](mailto:ask-it@epsi-europe.com)  
I: [www.epsi-europe.com](http://www.epsi-europe.com)

**YOU ASK IT.  
WE MASK IT.**

# HV90

## V-Hooks 90° Bend

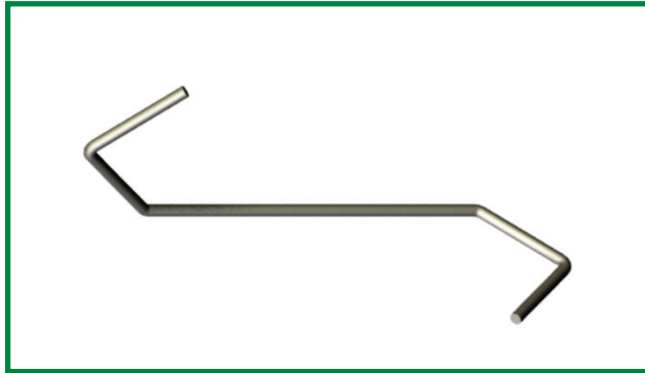

- V-Hook Geometry is Extremely Stable Under Loads (as compared to other hook geometries)
- 90° Bend Allows for Specific Hanging Orientation

Explanation of new Hook product numbers:  
(ie; HV90 15045-2525)

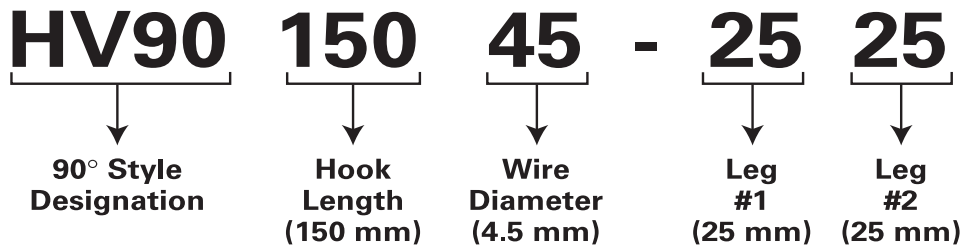

LOAD TABLE: V-Hooks				
Wire Diameter	6.0 mm	0.25"	*	
	4.5 mm	0.18"	80 kilos	
	3.0 mm	0.12"	36 kilos	
	2.0 mm	0.08"	11 kilos	
	1.5 mm	0.06"	5.5 kilos	
Safe Load Limits				

NOTE: The recommended safe load limits were compiled under static load conditions in a laboratory fully accredited by the American Association for Laboratory Accreditation, conforming to ISO Guide 25. Although all load limits incorporate a safety factor, many factors will affect the actual dynamic load capacity of a hook. Such factors include sudden change in line speed, vibration in the conveyor, or in the case of suspension from two hooks, a shift in the center of gravity caused by an incline or stretching along curves in the conveyor. This product should be tested to determine the suitability for its intended use.

\* Please call your EPSI representative for further details.

# HV-90 SERIES

PART NUMBER	OVERALL LENGTH	STANDARD (IN.)			METRIC (MM)			BOX QTY	
		WIRE DIA	LEG 1	LEG 2	OVERALL LENGTH	WIRE DIA	LEG 1		LEG 2
HV90 07515-2121	3	0.06	0.81	0.81	75	1.5	21	21	2500
HV90 10015-2121	4	0.06	0.81	0.81	100	1.5	21	21	2500
HV90 15015-2525	6	0.06	1.00	1.00	150	1.5	25	25	2500
HV90 07520-2121	3	0.08	0.81	0.81	75	2.0	21	21	2500
HV90 10020-2121	4	0.08	0.81	0.81	100	2.0	21	21	2500
HV90 15020-2525	6	0.08	1.00	1.00	150	2.0	25	25	2500
HV90 20020-2525	8	0.08	1.00	1.00	200	2.0	25	25	2500
HV90 37520-2525	15	0.08	1.00	1.00	375	2.0	25	25	1000
HV90 45020-2525	18	0.08	1.00	1.00	450	2.0	25	25	1000
HV90 10030-2525	4	0.12	1.00	1.00	100	3.0	25	25	1000
HV90 15030-2525	6	0.12	1.00	1.00	150	3.0	25	25	1000
HV90 20030-2525	8	0.12	1.00	1.00	200	3.0	25	25	1000
HV90 25030-2525	10	0.12	1.00	1.00	250	3.0	25	25	1000
HV90 30030-2525	12	0.12	1.00	1.00	300	3.0	25	25	500
HV90 60030-2525	24	0.12	1.00	1.00	600	3.0	25	25	250
HV90 75030-2525	30	0.12	1.00	1.00	750	3.0	25	25	250
HV90 15045-2525	6	0.18	1.00	1.00	150	4.5	25	25	500
HV90 30045-2525	12	0.18	1.00	1.00	300	4.5	25	25	250
HV90 45045-2525	18	0.18	1.00	1.00	450	4.5	25	25	250
HV90 15060-2525	6	0.25	1.00	1.00	150	6.0	25	25	500
HV90 20060-2525	8	0.25	1.00	1.00	200	6.0	25	25	500
HV90 30060-2525	12	0.25	1.00	1.00	300	6.0	25	25	250

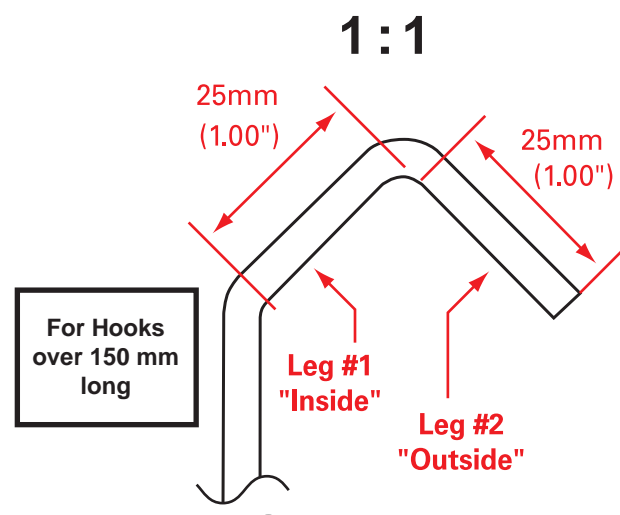
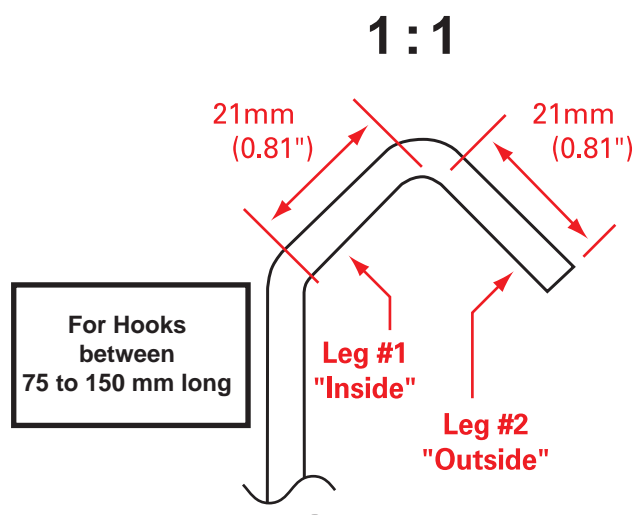

# HS S-Hooks

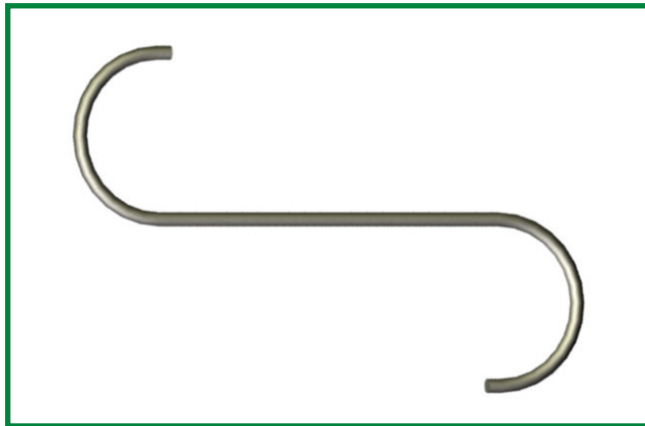

- Can be Used in Combination to Daisy Chain Multiple Items Together
- Ideal for Wider Parts or Multiple Styles of Parts with Varying Thicknesses

**Explanation of new Hook product numbers:**  
(ie; HS 15045-38)

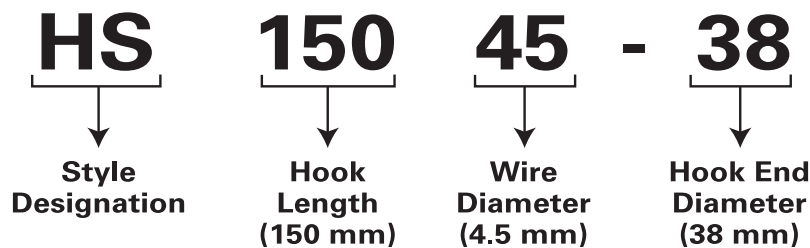

LOAD TABLE: S-Hooks				
Wire Diameter	6.0 mm	0.25"		*
	4.5 mm	0.18"		55 kilos
	3.0 mm	0.12"		25 kilos
	2.0 mm	0.08"		8 kilos
	1.5 mm	0.06"		4 kilos
				Safe Load Limits

**NOTE:** The recommended safe load limits were compiled under static load conditions in a laboratory fully accredited by the American Association for Laboratory Accreditation, conforming to ISO Guide 25. Although all load limits incorporate a safety factor, many factors will affect the actual dynamic load capacity of a hook. Such factors include sudden change in line speed, vibration in the conveyor, or in the case of suspension from two hooks, a shift in the center of gravity caused by an incline or stretching along curves in the conveyor. This product should be tested to determine the suitability for its intended use.

\* Please call your EPSI representative for further details.



# HC C-Hooks

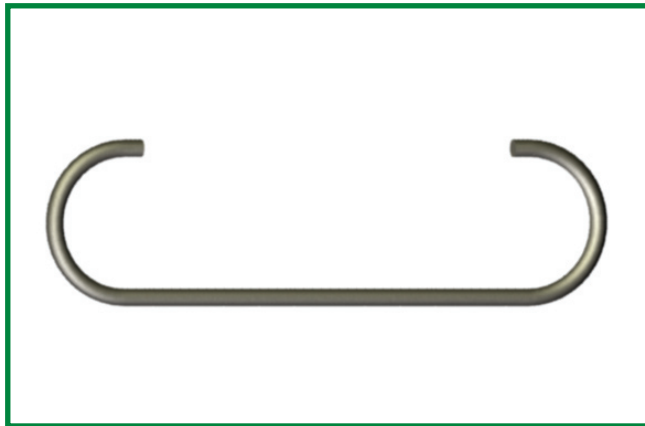

- Can be Used in Combination to Daisy Chain Multiple Items Together
- Ideal for Wider Parts or Multiple Styles of Parts with Varying Thicknesses

## Explanation of new Hook product numbers: (ie; HC 15045-38)

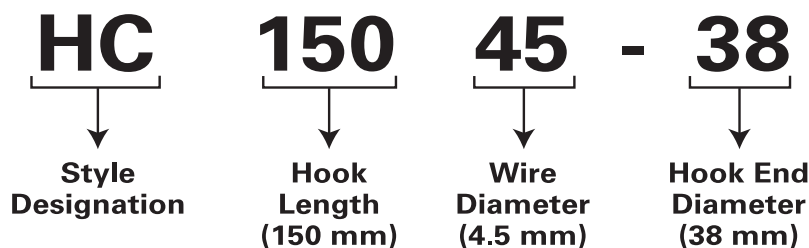

LOAD TABLE: C-Hooks			
Wire Diameter	6.0 mm	0.25"	*
	4.5 mm	0.18"	55 kilos
	3.0 mm	0.12"	25 kilos
	2.0 mm	0.08"	8 kilos
	1.5 mm	0.06"	4 kilos
			Safe Load Limits

**NOTE:** The recommended safe load limits were compiled under static load conditions in a laboratory fully accredited by the American Association for Laboratory Accreditation, conforming to ISO Guide 25. Although all load limits incorporate a safety factor, many factors will affect the actual dynamic load capacity of a hook. Such factors include sudden change in line speed, vibration in the conveyor, or in the case of suspension from two hooks, a shift in the center of gravity caused by an incline or stretching along curves in the conveyor. This product should be tested to determine the suitability for its intended use.

\* Please call your EPSI representative for further details.



# HCV CV-Hooks

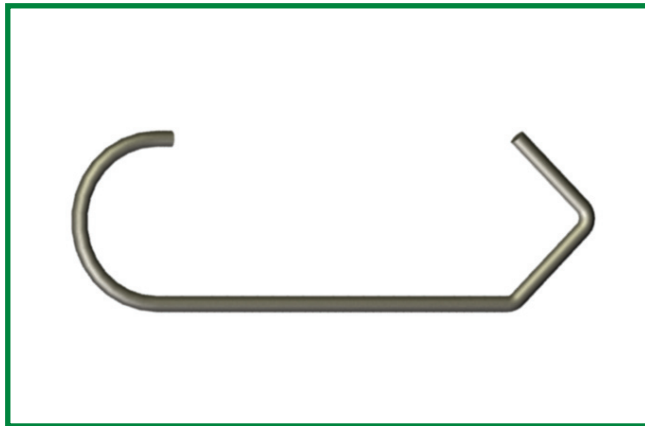

- Hybrid Hook Configuration
- Combines the Features of a V-Hook with the Ease of Use of a C-Hook
- Can be Used on Both Traditional and Round Stock Conveyor Systems
- Offer the Greatest Load Capacity with the Smallest Amount of Hook Marking

## Explanation of new Hook product numbers: (ie; HCV 15045-32)

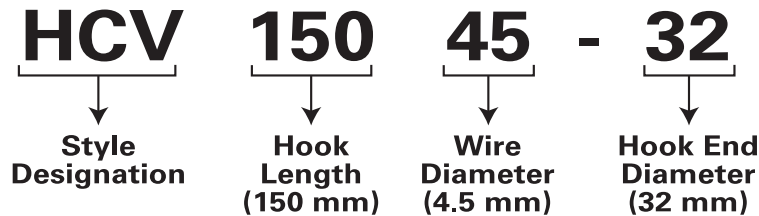

LOAD TABLE: CV-Hooks				
Wire Diameter	6.0 mm	0.25"	*	
	4.5 mm	0.18"	55 kilos	
	3.0 mm	0.12"	25 kilos	
	2.0 mm	0.08"	8 kilos	
	1.5 mm	0.06"	4 kilos	
				Safe Load Limits

**NOTE:** The recommended safe load limits were compiled under static load conditions in a laboratory fully accredited by the American Association for Laboratory Accreditation, conforming to ISO Guide 25. Although all load limits incorporate a safety factor, many factors will affect the actual dynamic load capacity of a hook. Such factors include sudden change in line speed, vibration in the conveyor, or in the case of suspension from two hooks, a shift in the center of gravity caused by an incline or stretching along curves in the conveyor. This product should be tested to determine the suitability for its intended use.

\* Please call your EPSI representative for further details.

■ For current pricing and additional sizes, send your e-mail to: [ask-it@epsi-europe.com](mailto:ask-it@epsi-europe.com)

# HCV SERIES

PART NUMBER	LENGTH (in)	STANDARD WIRE DIA (in)	DIAMETER (in)	LENGTH (mm)	METRIC WIRE DIA (mm)	DIAMETER (mm)	BOX QTY
HCV 07515-25	3	0.06	1.00	75	1.5	25	2500
HCV 10015-32	4	0.06	1.25	100	1.5	32	2500
HCV 15015-38	6	0.06	1.50	150	1.5	38	2500
HCV 07520-25	3	0.08	1.00	75	2.0	25	2500
HCV 10020-32	4	0.08	1.25	100	2.0	32	2500
HCV 15020-38	6	0.08	1.50	150	2.0	38	2500
HCV 20020-38	8	0.08	1.50	200	2.0	38	2500
HCV 25020-38	10	0.08	1.50	250	2.0	38	2500
HCV 10030-32	4	0.12	1.25	100	3.0	32	1000
HCV 15030-38	6	0.12	1.50	150	3.0	38	1000
HCV 20030-38	8	0.12	1.50	200	3.0	38	1000
HCV 25030-38	10	0.12	1.50	250	3.0	38	1000
HCV 30030-38	12	0.12	1.50	300	3.0	38	500
HCV 37530-38	15	0.12	1.50	375	3.0	38	500
HCV 45030-38	18	0.12	1.50	450	3.0	38	500
HCV 15045-38	6	0.18	1.50	150	4.5	38	500
HCV 20045-38	8	0.18	1.50	200	4.5	38	500
HCV 25045-38	10	0.18	1.50	250	4.5	38	250
HCV 30045-38	12	0.18	1.50	300	4.5	38	250
HCV 45045-38	18	0.18	1.50	450	4.5	38	250
HCV 60045-38	24	0.18	1.50	600	4.5	38	100
HCV 30060-38	12	0.25	1.50	300	6.0	38	250

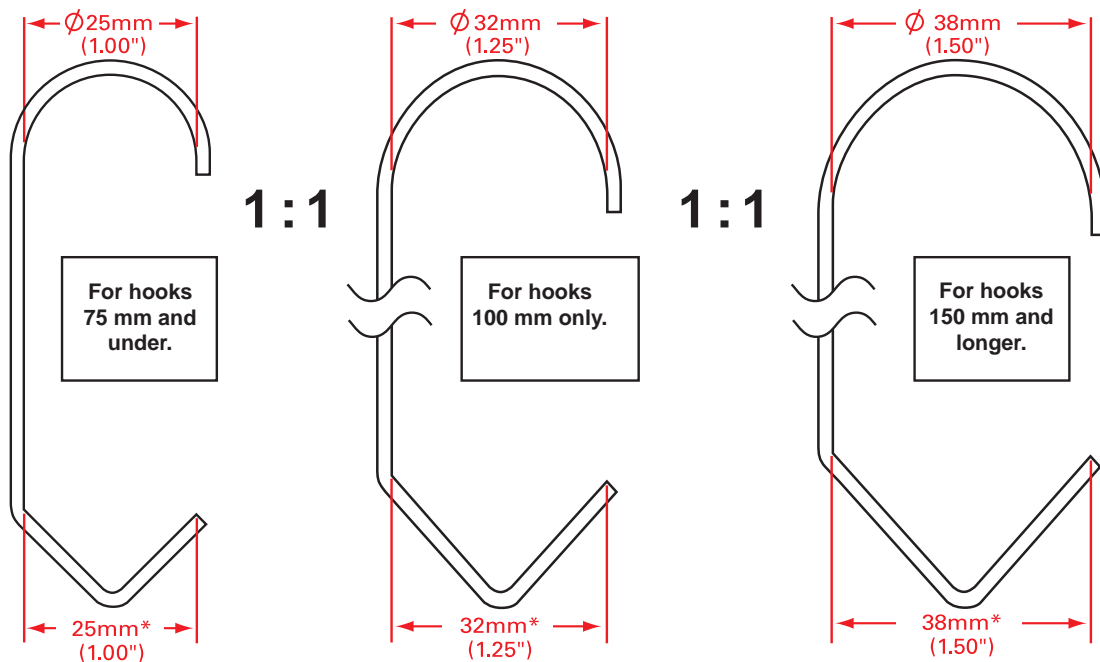

# HKVL V-Style Locking Hooks

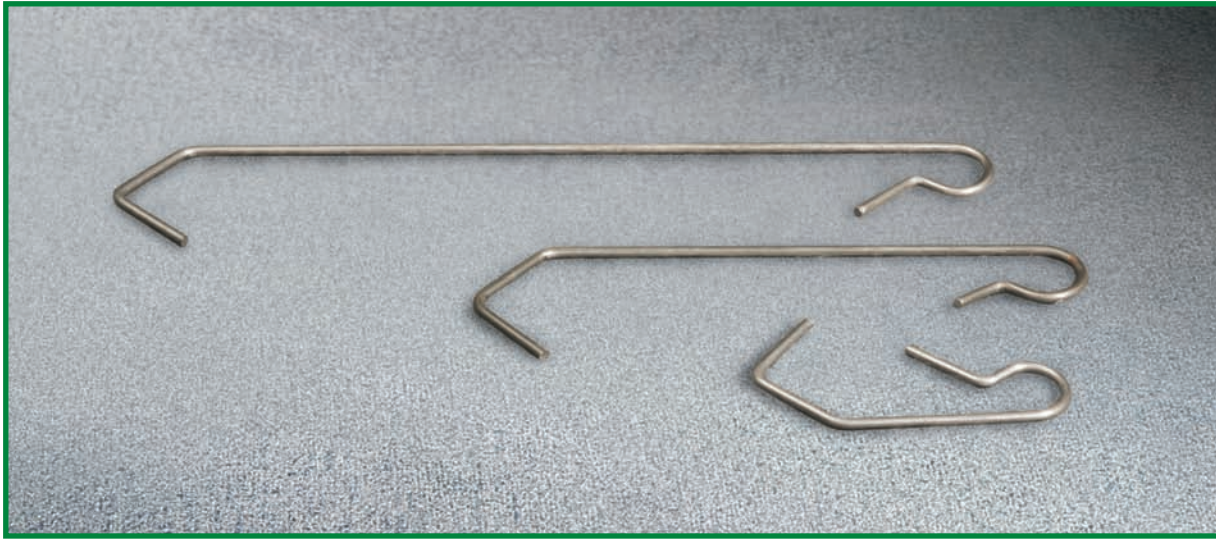

■ Designed to Fit Around Contact Points of Most Suspension Systems and Rods

■ Locking Eyelet Design Ensures that Hook will not Fall Off of Beams

## HKVL SERIES

PART NUMBER	STANDARD		METRIC		FITS ROD DIA (in)	BOX QTY
	LENGTH (in)	WIRE DIA (in)	LENGTH (mm)	WIRE DIA (mm)		
HKVL 375044-4	4	0.04	100	1.0	3/8	2500
HKVL 188060-2	2	0.06	50	1.5	3/16	2500
HKVL 188060-4	4	0.06	100	1.5	3/16	2500
HKVL 188060-6	6	0.06	150	1.5	3/16	2500
HKVL 250060-2	2	0.06	50	1.5	1/4	2500
HKVL 250060-4	4	0.06	100	1.5	1/4	2500
HKVL 250060-6	6	0.06	150	1.5	1/4	2500
HKVL 375060-4	4	0.06	100	1.5	3/8	2500
HKVL 375080-2	2	0.08	50	2.0	3/8	2500
HKVL 375080-4	4	0.08	100	2.0	3/8	2500
HKVL 375080-6	6	0.08	150	2.0	3/8	2500

■ For current pricing and additional sizes, send your e-mail to: [ask-it@epsi-europe.com](mailto:ask-it@epsi-europe.com)

# CLAW

## Claw Hooks

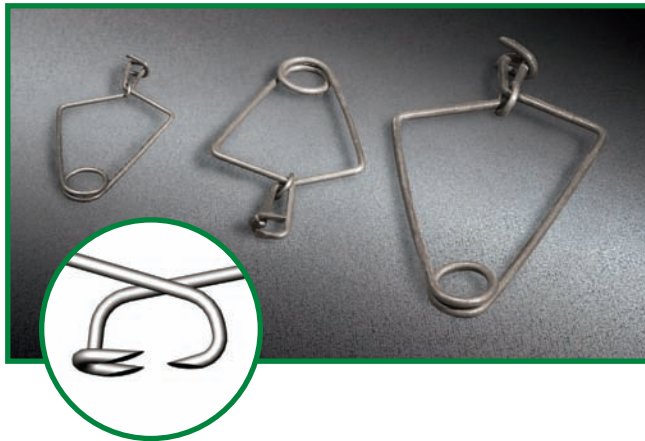

- Our new claw hooks are designed to handle the most unusual of hanging situations. Their unique clamping action and strong contact points allow even the most unconventional of items to be hung.

- Available in Three Different Strengths:
  - Claw 200—(Light Duty to 2.3 kilos)
  - Claw 300—(Medium Duty to 4.5 kilos)
  - Claw 400—(Heavy Duty to 18 kilos)

### CLAW SERIES

PART NUMBER	STANDARD		METRIC		NO. OF PRONGS	BOX QTY
	LENGTH (in)	WIRE DIA (in)	LENGTH (mm)	WIRE DIA (mm)		
CLAW 200	2.4	0.080	60	2.0	3	50
CLAW 300	4.8	0.120	120	3.0	3	50
CLAW 400	6.5	0.160	165	4.0	3	50

# HKSC

## Sheet & Pipe Suspender Hook



- Made of Cold Rolled Steel
- Reusable
- Suitable for Products that Have no Holes for Suspension
- Accepts Sheet Metal up to 4.0mm (.160") Thick
- Has Holes for Use with Standard Hooks for Easy Hanging

### HKSC 002040 SERIES

PART NUMBER	STANDARD		METRIC		BOX QTY
	PART THICKNESS (in)	PART THICKNESS (mm)	PART THICKNESS (mm)	PART THICKNESS (mm)	
HKSC 002040	0.080 - 0.157	2.0 - 4.0	2.0 - 4.0	2.0 - 4.0	50

■ For current pricing and additional sizes, send your e-mail to: [ask-it@epsi-europe.com](mailto:ask-it@epsi-europe.com)



T: +31 (0)10 4150155  
F: +31 (0)10 4154099

93

E: [ask-it@epsi-europe.com](mailto:ask-it@epsi-europe.com)  
I: [www.epsi-europe.com](http://www.epsi-europe.com)

**YOU ASK IT.  
WE MASK IT.**

# HKRO

## Spring Tube Hooks

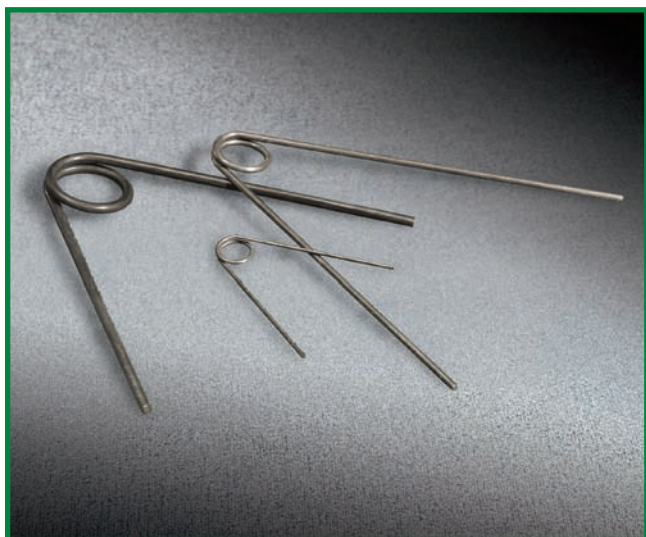

- Easy to Apply
- Allows for Hook Marks to be Hidden Inside of Holes and Other Non-Cosmetic Features
- Flexible Enough to Fit a Variety of Otherwise Difficult Applications
- Available in Three Different Strengths

■ **CAUTION!** Please exercise caution when removing Spring Tube Hooks as they will expand quickly and with great force.



### HKRO SERIES

PART NUMBER	STANDARD LENGTH (in)	STANDARD WIRE DIA (in)	METRIC LENGTH (mm)	METRIC WIRE DIA (mm)	BOX QTY
HKRO 100	1.770	0.040	45	1.0	250
HKRO 200	4.130	0.080	105	2.0	250
HKRO 300	4.250	0.120	108	3.0	250

■ For current pricing and additional sizes, send your e-mail to: [ask-it@epsi-europe.com](mailto:ask-it@epsi-europe.com)



T: +31 (0)10 4150155  
F: +31 (0)10 4154099

94

E: [ask-it@epsi-europe.com](mailto:ask-it@epsi-europe.com)  
I: [www.epsi-europe.com](http://www.epsi-europe.com)

**YOU ASK IT.  
WE MASK IT.**

# SWIVEL Swivel Hooks

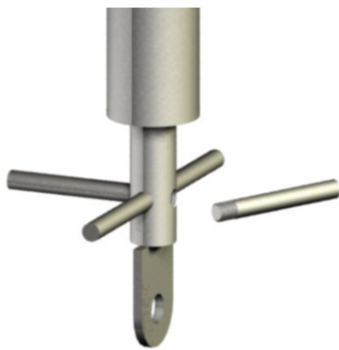
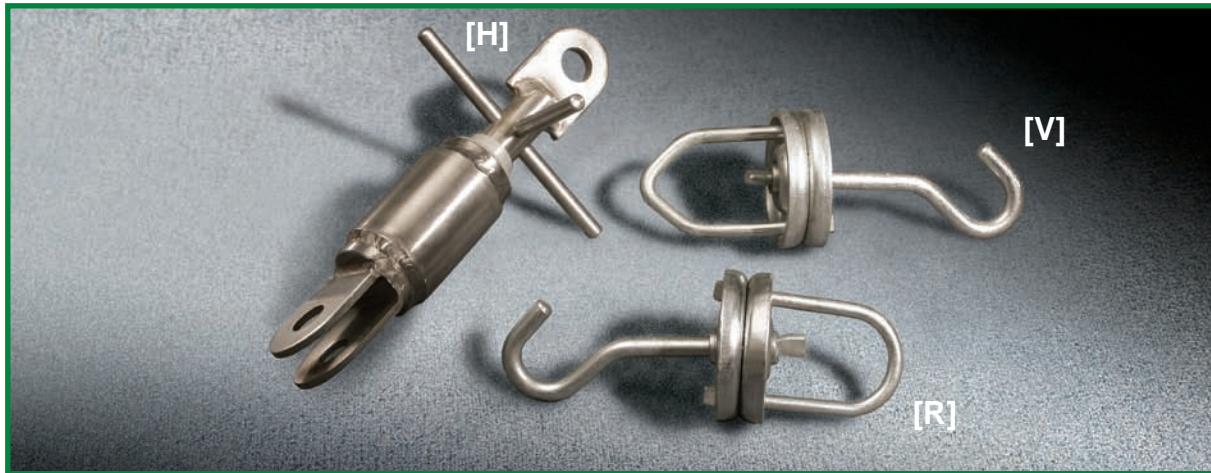

## [H] SERIES

- Stainless Steel Construction
- Holds up to 680 kilos
- Internal Mechanism is Completely Sealed
- Ball Bearings Ensure Smooth Rotation Even Under Loading
- Features Removable Pins for Adaptation to Indexing Conveyor Lines
- Designed to Rotate in Only One Direction

## [R] & [V] SERIES

- Cold Rolled Steel Construction
- Holds up to 110 kilos
- Ball Bearings Ensure Smooth Rotation Even Under Loading
- Feature a V-Shaped (Swivel-V) or a Radial (Swivel-R) Hanging Point
- Available in Cold-Rolled

## [R] SERIES



## [V] SERIES



## [H], [R] & [V] SERIES

PART NUMBER	STANDARD LOAD CAPACITY (LBS)	METRIC LOAD CAPACITY (Kg)	ROTATION	BOX QTY
SWIVEL (H)	1500	680	45 degree increments	1
SWIVEL (R)	250	110	Infinite	2
SWIVEL (V)	250	110	Infinite	2

■ For current pricing and additional sizes, send your e-mail to: [ask-it@epsi-europe.com](mailto:ask-it@epsi-europe.com)



T: +31 (0)10 4150155  
F: +31 (0)10 4154099

E: [ask-it@epsi-europe.com](mailto:ask-it@epsi-europe.com)  
I: [www.epsi-europe.com](http://www.epsi-europe.com)

**YOU ASK IT.  
WE MASK IT.**